



VITERIA INOX A2

VITI TESTA CILINDRICA CON ESAGONO INCASSATO INOX A2 _____	12
VITI A TESTA SVASATA PIANA CON ESAGONO INCASSATO INOX A2 _____	15
VITI A TESTA BOMBATA CON ESAGONO INCASSATO INOX A2 _____	18
VITI TESTA ESAGONALE PARZIALMENTE FILETTATE INOX A2 _____	27
VITI TESTA ESAGONALE TOTALMENTE FILETTATE INOX A2 _____	38
DADI ESAGONALI INOX A2 _____	51
DADI CECHI INOX A2 _____	55
DADI AD ALETTE INOX A2 _____	55
DADI AUTOBLOCCANTI INOX A2 _____	61
GRANI INOX A2 _____	65
VITI TRUCIOLARI TESTA SVASATA PIANA INOX A2 _____	70
AUTOFILETTANTI	
• Testa cilindrica taglio + Inox A2 _____	77
• Testa svasata piana taglio + Inox A2 _____	77
• Testa svasata calotta taglio + Inox A2 _____	77





VITERIA INOX A2

VITI PER METALLO TAGLIO CACCIAVITE

- Testa cilindrica Inox A2 _____ 85
- Testa svasata piana Inox A2 _____ 86
- Testa svasata calotta Inox A2 _____ 87
- Microviti testa cilindrica Inox A2 _____ 88
- Microviti testa svasata piana Inox A2 _____ 88

VITI PER METALLO TAGLIO CROCE

- Testa cilindrica Inox A2 _____ 91
- Testa svasata piana Inox A2 _____ 91
- Testa svasata calotta Inox A2 _____ 91
- Microviti testa cilindrica Inox A2 _____ 92
- Microviti testa svasata piana Inox A2 _____ 92

VITI POILIERS TAGLIO INOX A2 _____ 94

BULLONI TESTA TONDA CON QUADRO SOTTOTESTA INOX A2 _____ 97

COPIGLIE UNI 1336 INOX A2 _____ 103

RIVETTI INOX A2 _____ 111

RONDELLE

- Grebiuline Inox A2 _____ 128
- Piane Inox A2 _____ 128
- Rondelle grower Inox A2 _____ 133
- Dentellate esterne - interne Inox A2 _____ 133

BARRE FILETTATE INOX A2 _____ 151

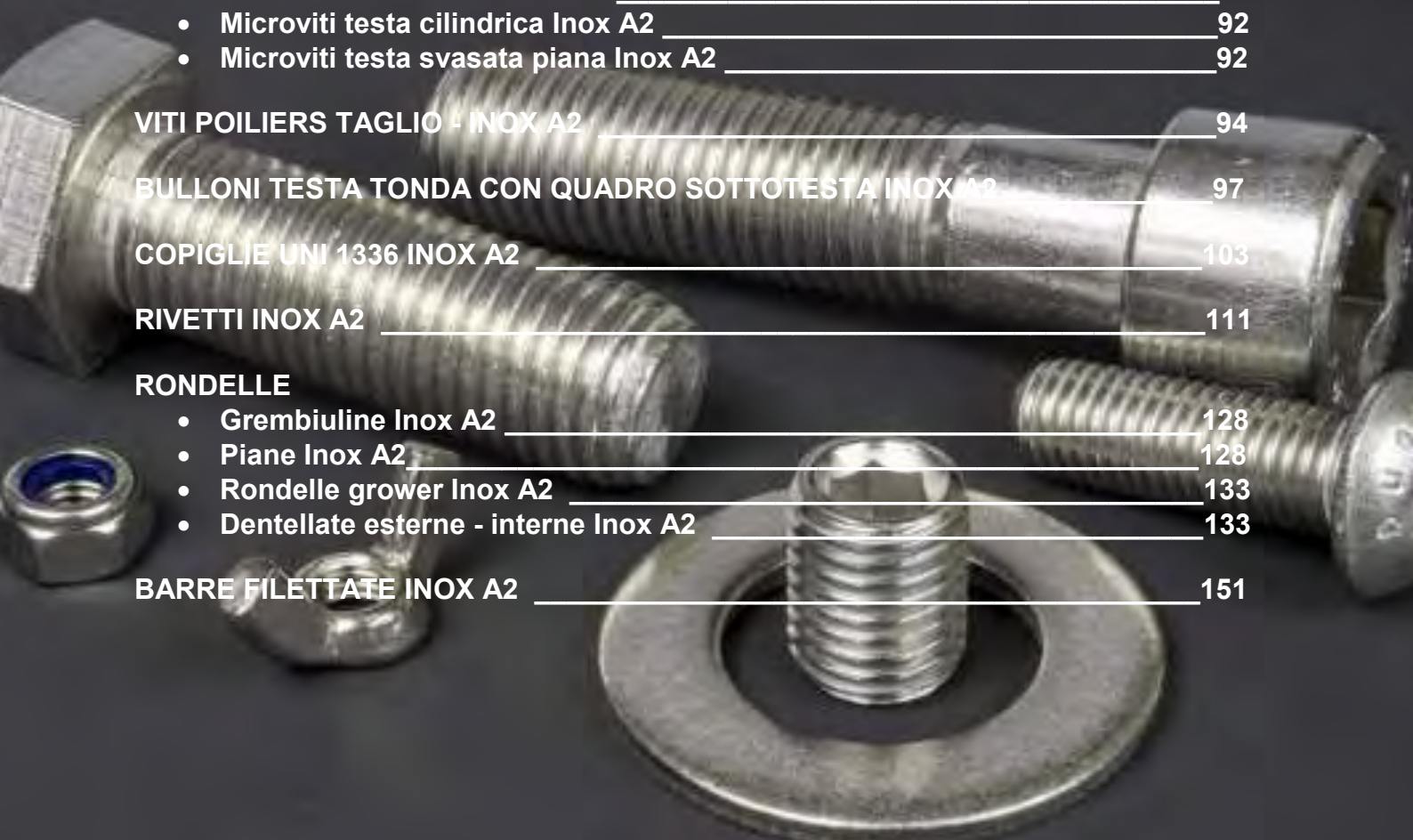

UNI 5931 DIN 912

INOX A2 AISI 304



Viti acciaio inox testa cilindrica con esagono incassato

Filettatura metrica ISO a passo grosso

Art. 1530

d	3	4	5	6	8	10	12	14	16	20	24
passo	0,5	0,7	0,8	1	1,25	1,5	1,75	2	2	2,5	3
D	5,5	7	8,5	10	13	16	18	21	24	30	36
K	3	4	5	6	8	10	12	14	16	20	24
S	2,5	3	4	5	6	8	10	12	14	17	19
t	1,3	2,2	2,9	3,5	4,5	5,9	7	8,3	9,3	11,2	13,5

**l = Lunghezza
in mm**

Prezzo base in €uro per 100 pezzi

6	5,12	5,12	8,01								
8	4,80	4,38	5,60	8,01							
10	4,48	4,03	4,33	6,80	14,09						
12	4,16	3,79	4,28	5,32	12,16						
14	4,80	4,28	5,02	7,53	15,34						
16	4,48	4,17	4,33	5,6	11,35	27,52					
20	5,12	4,26	4,74	6,49	12,97	20,78	32,13		112,07		
25	5,76	5,05	5,88	7,03	13,23	21,90	31,12	100,86	104,90		
30	6,72	5,67	7,03	7,87	14,69	23,73	33,78	100,86	100,06	256,16	
35	8,01	6,53	8,13	9,48	16,31	25,95	36,83	105,67	100,06	256,16	
40	8,81	7,16	8,95	10,36	18,71	27,07	40,23	112,07	103,74	256,16	800,51
45		10,33	10,74	12,06	22,21	30,74	42,35	120,08	113,79	271,14	800,51
50		11,88	13,11	13,78	23,83	34,08	45,84	126,48	116,30	280,18	800,51
55			16,11	15,93	25,50	39,00	51,50	136,09	128,02	304,19	0,00
60			17,51	17,04	28,01	42,27	55,83	144,09	135,41	320,20	896,57
70			27,22	24,28	33,83	51,45	68,84	168,11	159,04	368,23	1.088,69
80			32,02	30,99	44,66	61,05	82,43	192,12	187,20	448,28	1.200,76
90				33,62	53,42	74,89	95,52	224,14	219,37	480,30	1.344,85
100				44,83	59,08	86,70	107,78	256,16	245,70	512,33	1.472,94
110				56,04	88,06	128,08	152,10	288,18	288,18	608,39	1.681,07
120				64,04	100,86	144,09	168,11	312,20	312,20	672,43	1.761,12
130				72,05	112,07	160,10	200,13	344,22	344,22	768,49	2.001,27
140				88,06	123,28	176,11	224,14	376,24	376,24	880,56	2.161,37
150				104,07	134,49	192,12	248,16	400,25	400,25	960,61	2.321,47

UNI 5933 DIN 7991

INOX A2 AISI 304

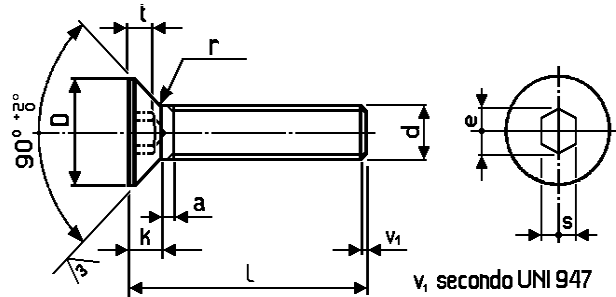

Viti acciaio inox a testa svasata piana con esagono incassato

Filettatura metrica ISO a passo grosso

Art. 1540

d	3	4	5	6	8	10	12	16	20
passo	0,5	0,7	0,8	1	1,25	1,5	1,75	2	2,5
D	6	8	10	12	16	20	24	30	36
K	1,7	2,3	2,8	3,3	4,4	5,5	6,5	7,5	8,5
S	2	2,5	3	4	5	6	8	10	12
t	1,3	2	2,4	2,8	3,8	4,8	5	5,8	6,5

**l = Lunghezza
in mm**

Prezzo base in €uro per 100 pezzi

6	4,80	4,80	8,01						
8	4,48	4,48	5,76	6,40					
10	4,00	4,00	4,48	6,03	12,91				
12	3,84	3,84	4,48	5,28	10,41				
14	4,16	4,16	5,28	6,40	13,61				
16	3,84	3,84	4,48	5,44	10,41	27,54			
20	4,48	4,48	4,96	6,08	11,53	20,81	43,23		
25	5,44	5,44	5,76	6,88	12,17	22,41	46,43	192,12	
30	6,40	6,40	6,72	8,01	13,77	24,82	51,23	160,10	
35	7,20	7,20	8,17	9,13	16,01	27,70	54,43	168,11	
40	8,49	8,49	9,29	10,57	18,25	29,62	59,24	176,11	352,22
45		10,41	12,01	12,49	20,49	33,62	64,04	184,12	368,23
50		11,53	13,61	13,61	23,21	36,82	67,24	200,13	384,24
55			19,11	15,69	25,62	41,63	75,75		
60			20,01	17,90	28,18	44,03	88,06	216,14	416,26
65			27,37	23,76	35,64	59,24	108,46		
70			28,82	25,31	38,42	57,64	112,07	256,16	480,30
80			43,23	33,62	49,63	80,05	132,88	272,17	560,36
90				40,03	59,24	96,06	140,89	296,19	608,39
100				48,03	64,04	112,07	147,29	320,20	656,42

ISO 7380

INOX A2 AISI 304

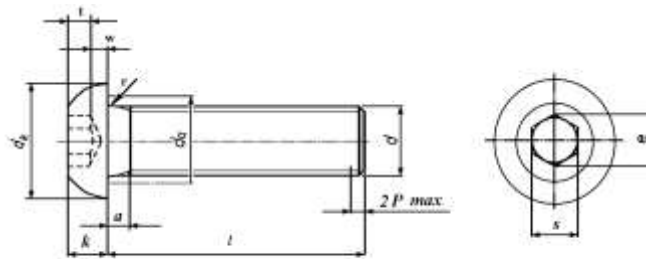

Viti acciaio inox a testa bombata con esagono incassato

Art. 4055

d	3	4	5	6	8	10	12
passo	0,5	0,7	0,8	1	1,25	1,5	1,75
D max	5,7	7,6	9,5	10,5	14	17,5	21
K max	1,65	2,2	2,75	3,3	4,4	5,5	6,6
s	2	2,5	3	4	5	6	8

I = Lunghezza
in mm.

Prezzo base in €uro per 100 pezzi

I	3	4	5	6	8	10	12
6	3,55	3,87					
8	3,07	3,07	4,36	5,97			
10	3,39	3,39	4,68	5,65	13,72	25,82	
12	3,71	3,71	4,84	5,97	13,72		
14	4,03	4,03	5,49	6,46	14,98		
16	4,03	4,03	5,16	6,78	13,40	27,43	
20	4,52	4,52	5,81	7,43	14,04	29,05	
25	4,84	4,84	6,78	8,07	14,85	32,28	54,87
30	7,26	5,81	7,26	9,04	17,76	35,51	59,72
35		8,07	8,07	10,49	20,17	40,35	66,17
40		9,68	8,88	11,62	23,40	42,77	71,01
45				13,56	26,63	45,19	75,85
50			19,37	15,49	29,86	51,65	80,70
60				17,76	37,12	64,56	93,61

UNI 5737 DIN 931

INOX A2 AISI 304

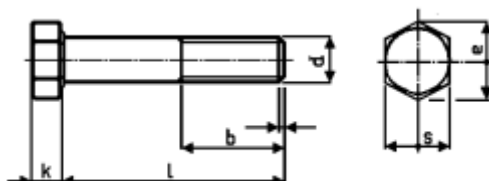

Viti acciaio inox a testa esagonale

Gambo parzialmente filettato - filettatura metrica ISO a passo grosso

Art. 1510

d	5	6	8	10	12	14	16	18	20	22	24
passo	0,8	1	1,25	1,5	1,75	2	2	2,5	2,5	2,5	3
S	8	10	13	17	19	22	24	27	30	32	36
K	3,5	4	5,5	7	8	9	10	12	13	14	15
b (1<126)	16	18	22	26	30	34	38	42	46	50	54
b (125<201)			28	32	36	40	44	48	52	56	60

l = Lunghezza
in mm.

Prezzo base in €uro per 100 pezzi

25	8,49	8,02									
30	8,01	7,51	15,84								
35	8,81	8,48	15,84	29,05							
40	9,61	9,40	17,27	29,05	43,58						
45	11,21	10,32	18,85	30,65	43,58	80,71	83,57				
50	12,81	11,14	19,64	32,13	44,44	82,49	90,26				
55	16,01	12,97	22,12	35,60	48,63	85,51	90,46				
60	16,01	13,79	22,98	37,70	51,18	90,15	93,37	181,64	181,64		
65		16,49	25,97	39,59	54,14	96,13	104,00	175,20	175,20		
70		17,36	28,10	42,04	57,82	101,55	106,14	181,84	181,84	480,30	561,96
75		22,41	30,83	45,21	61,09	108,19	114,93	196,27	196,27		561,96
80		24,02	34,22	49,14	67,94	113,40	120,45	204,32	204,32	480,30	427,63
90		28,82	40,10	53,33	75,85	130,76	143,02	224,75	224,75	528,34	464,81
100		33,62	46,24	65,08	82,75	148,08	155,38	246,20	246,20	576,37	527,92
110		38,42	56,04	81,78	92,81	150,17	173,16	261,94	261,94	640,41	531,90
120		51,23	62,44	92,86	107,27	168,05	181,33	294,73	294,73	688,44	595,63
130		57,64	68,84	112,07	140,89	208,13	185,92	352,22	314,14	736,47	619,54
140		59,24	77,47	128,08	152,10	224,14	225,77	384,24	353,98	800,51	658,74
150		64,04	84,85	144,09	168,11	248,16	244,16	416,26	384,12	880,56	721,13
160			137,72	176,11	200,13	482,02	278,90	480,30	441,84	1.040,66	779,59
170			149,77	197,97	240,15	636,95	357,56		526,11		943,62
180			175,60	227,24	256,16	688,59	381,57	929,62	583,85	1.232,78	998,72
200			222,08	278,89	320,20	800,51	432,14	981,27	645,67	1.344,85	1.176,02

UNI 5739 DIN 933

INOX A2 AISI 304

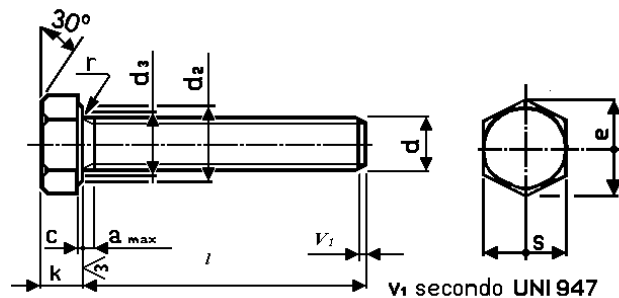

Viti acciaio inox a testa esagonale

Gambo interamente filettato - filettatura metrica ISO a passo grosso

Art. 1500

d	4	5	6	8	10	12	14	16	18	20	22	24
Passo	0,7	0,8	1	1,25	1,5	1,75	2	2	2,5	2,5	2,5	3
S	7	8	10	13	17	19	22	24	27	30	32	36
K	2,8	3,5	4	5,5	7	8	9	10	12	13	14	15

l = Lunghezza
in mm.

Prezzo base in €uro per 100 pezzi

6	4,13											
8	4,13	4,82	5,85									
10	4,13	4,01	5,01	11,36	24,96							
12	4,12	3,89	4,81	10,02	24,10							
14	4,58	4,47	4,99	11,86	22,38							
16	4,65	4,22	4,73	9,20	18,41	36,15						
18	5,33	4,86	5,76	10,56	19,84							
20	5,00	4,70	5,22	9,97	18,71	31,14	65,34	79,19				
22	5,85	5,68	6,70	12,17	19,99							
25	5,68	5,18	6,00	11,07	19,63	29,81	64,93	64,93		189,37		
30	6,37	5,94	6,95	12,48	20,86	30,96	61,20	66,31	122,86	150,83		
35	7,34	6,46	7,86	13,75	23,47	33,54	64,22	64,96	129,77	127,31		
40	8,82	7,36	8,69	15,19	24,24	35,84	68,77	70,00	129,77	131,71	336,21	294,45
45	11,19	9,61	9,51	16,69	27,71	39,32	74,04	74,29	133,65	136,31	336,21	303,76
50	12,05	11,21	10,30	18,66	29,50	41,01	78,64	77,46	139,68	140,61	352,22	309,74
55		13,61	14,57	20,55	32,98	47,93	83,39	84,72	145,77	153,64	400,25	345,63
60		13,61	15,44	21,27	35,79	50,77	89,07	89,63	154,05	157,22	400,25	343,64
65			20,01	24,12	40,90	55,73	96,02	97,15	161,77	171,44	432,27	366,90
70			22,09	29,15	44,48	59,97	100,06	104,97	167,86	178,95	432,27	381,52
80			25,62	33,62	52,31	74,34	116,57	119,23	193,42	207,07	464,29	428,72
90			30,42	44,83	67,24	86,45	163,55	144,09	292,66	232,15	528,34	512,33
100			36,82	52,83	75,25	96,06	172,15	160,10	320,20	248,16	592,38	560,36

UNI 5587-8-9 DIN 934-936

INOX A2 AISI 304

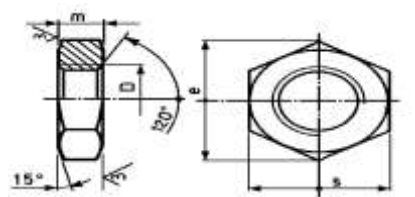
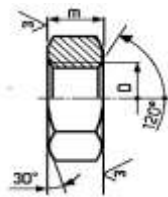
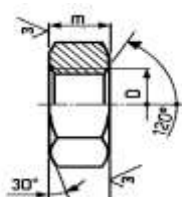

Dadi esagonali

Prezzo base in Euro per 100 pezzi

5587-65
Art. 1610

5588-65
Art. 1620

5589-65
Art. 1630

Misura	Chiave	Altezza	Prezzo	Misura	Chiave	Altezza	Prezzo	Misura	Chiave	Altezza	Prezzo
				2	4	1,6	2,00				
				2,5	5	2	1,97				
3	5,5	3	2,73	3	5,5	2,4	1,43	3	5,5		4,41
4	7	4	2,79	4	7	3,2	1,65	4	7		3,96
5	8	5	3,66	5	8	4	1,97	5	8	3	3,59
6	10	6	4,66	6	10	5	2,89	6	10	4	3,90
8	13	8	9,05	8	13	6,5	5,97	8	13	5	6,65
10	17	10	19,69	10	17	8	13,26	10	17	6	14,70
12	19	12	28,31	12	19	10	19,24	12	19	7	19,03
14	22	14	55,26	14	22	11	29,09	14	22	8	45,16
16	24	16	67,48	16	24	13	37,28	16	24	8	46,44
18	27	18	181,09	18	27	15	61,12	18	27	9	126,40
20	30	20	149,13	20	30	16	74,57	20	30	9	110,78
22	32	22	351,52	22	32	18	106,92	22	32	10	312,46
24	36	24	409,43	24	36	19	166,44	24	36	10	397,67
27	41	27	909,43	27	41	22	669,74	27	41	12	597,18
30	46	30	1.296,87	30	46	24	785,58	30	46	12	694,01
33	50	33	1.797,53	33	50	26	1.218,32	33	50	14	1.081,36
36	55	36	2.259,50	36	55	29	1.694,65	36	55	14	1.404,14

UNI 5721 DIN 1587

INOX A2 AISI 304

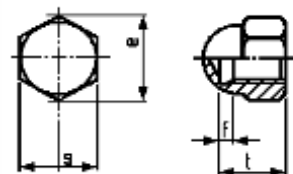

Dadi ciechi in acciaio con calotta sferica

Filettatura sistema metrico ISO a passo grosso

Art. 1640

Prezzo base in €uro per 100 pezzi

d	3	4	5	6	8	10	12	14	16	18	20	22	24
Prezzo	29,20	21,16	19,74	21,59	40,34	70,87	112,06	312,46	333,76	607,82	744,32	1096,49	1211,66

UNI 5448-71 DIN 314

INOX A2 AISI 304



Dadi ad alette

Art. 1660

Prezzo base in €uro per 100 pezzi

d	3	4	5	6	8	10	12	14	16	18	20
Prezzo	29,05	29,05	29,05	29,05	52,29	77,47	174,30	367,98	367,98	619,75	619,75

UNI 7474 DIN 985

INOX A2 AISI 304

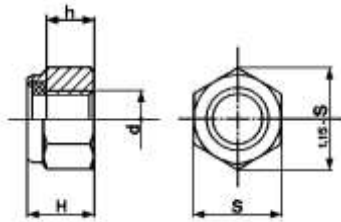

Dadi esagonali autobloccanti

Art. 1650

Prezzo base in €uro per 100 pezzi

d	3	4	5	6	8	10	12	14
Prezzo	4,09	3,84	4,01	4,41	9,02	19,88	29,83	56,01

d	16	18	20	22	24	27	30
Prezzo	67,74	379,48	383,47	672,43	859,07	1258,86	2616,37

UNI 5923-25-27-29

INOX A2 AISI 304

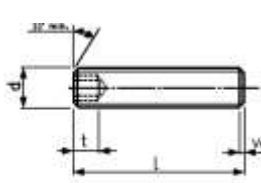

UNI 5923 DIN 913 Art. 1550

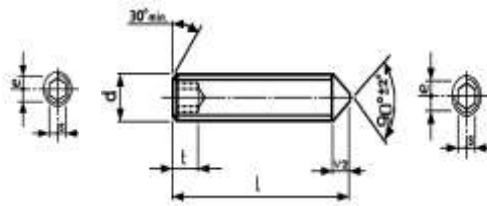

UNI 5927 DIN 914 Art. 1560

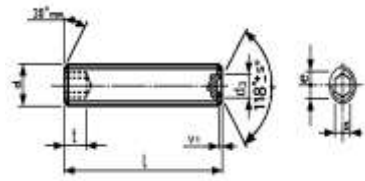

UNI 5929 DIN 916 Art. 1570

Viti senza testa con esagono incassato

Filettatura sistema metrico ISO a passo grosso

d	3	4	5	6	8	10	12
passo	0,5	0,7	0,8	1	1,25	1,5	1,75
S	1,5	2	2,5	3	4	5	6
t	2,5	3	3,5	4	5	6	8

**l = Lunghezza
in mm.**

Prezzo base in € per 100 pezzi

3	7,23						
4	5,82	5,88					
5	5,29	5,11	5,99				
6	5,41	5,29	5,58	6,46			
8	5,64	5,64	5,88	7,23	11,28		
10	6,11	5,88	6,35	7,64	11,28	20,80	
12	6,82	6,70	6,81	8,05	13,04	19,74	31,72
16	12,16	10,58	8,11	9,46	13,51	23,97	37,37
20	16,39	14,27	9,87	11,28	16,92	26,79	43,01
25		20,98	15,51	16,92	21,15	31,55	50,76
30		29,05	19,04	21,15	23,79	35,96	58,51
35		40,35	21,86	23,97	26,79	45,12	67,68
40		43,58	23,97	25,73	29,26	46,53	74,73
50			61,33	40,35	38,78	59,92	97,99

DIN 7505 A

INOX A2 AISI 304

Viti per pannelli truciolari con passo per legno

Testa svasata piana taglio a croce



Art. 1224

Prezzo base in €uro per 100 pezzi

DIAM.	3	3,5	4	4,5	5	6
Lunghezza in mm						
12	1,69	2,10				
16	1,85	2,42	2,74			
20	1,94	2,58	2,90	3,23	4,52	7,26
25	2,42	3,07	3,23	3,87	5,16	8,23
30	3,39	3,55	3,55	4,52	5,97	9,20
35		4,19	4,03	5,32	6,46	10,49
40		5,16	4,52	6,30	7,10	11,78
45			5,65	7,75	8,39	13,56
50			6,62	8,88	9,68	14,53
55				0,00	12,59	17,76
60			11,62	11,62	11,62	17,43
70					14,53	21,63
80					17,76	25,82
90					20,17	29,05
100					21,95	32,28

UNI 6954-6955-6956 DIN 7981-7982-7983

INOX A2 AISI 304

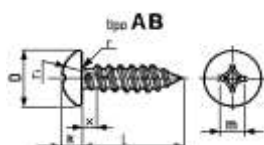

Art. 1100
UNI 6954 DIN 7981

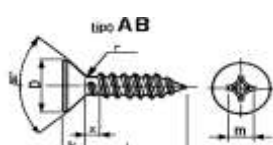

Art. 1110
UNI 6955 DIN 7982

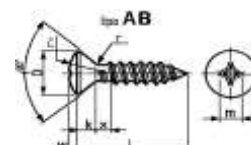

Art. 1120
UNI 6956 DIN 7983

Viti autofilettanti taglio a croce

Prezzi base in € per 100 pezzi

Diametro in mm	2,2	2,9	3,5	3,9	4,2	4,8	5,5	6,3
Lunghezza in mm								
6,5	1,96	1,25	1,50	1,88	2,24			
9,5	1,96	1,25	1,50	1,88	2,06	3,37		
13	2,14	1,37	1,64	2,03	2,24	3,37	5,29	6,39
16	2,14	1,49	1,71	2,19	2,50	3,74	5,64	6,88
19		1,68	1,92	2,62	2,77	4,04	6,03	7,95
22		2,03	2,21	2,90	2,99	4,45	6,89	8,64
25		2,23	2,78	3,06	3,18	4,64	7,48	9,59
32		4,54	3,13	4,19	4,19	5,24	8,77	11,14
38			3,67	4,47	5,05	6,36	9,60	12,33
45			8,26	7,75	6,54	8,64	12,93	15,61
50			9,30	8,26	7,89	9,58	14,22	17,57
60					15,49	13,99	15,95	19,37
70					22,72	18,92	21,63	25,68
80						24,68	28,88	34,70

UNI 6107 DIN 84

INOX A2 AISI 304

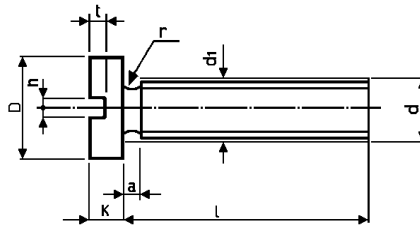

UNI 6107 - TC - DIN 84

Viti testa cilindrica taglio cacciavite

Art. 1580

Prezzo base in €uro per 100 pezzi

D	3	4	5	6	8
DxK	5,5X2	7X2,6	8,5X3,3	10X3,9	13X5
Lunghezza					
5	1,40	2,47			
6	1,36	2,40	5,68		
8	1,48	2,51	4,37	5,30	
10	1,55	2,55	4,18	5,22	14,77
12	1,70	2,69	4,46	5,47	14,77
14	1,88	3,03	5,00	6,11	16,35
16	1,88	3,03	5,00	6,11	16,35
20	2,17	3,36	5,54	6,87	16,35
25	2,55	3,87	6,43	7,76	19,52
30	2,88	4,39	7,09	8,61	23,74
35	4,02	4,80	8,37	9,46	31,12
40	5,50	5,87	9,11	10,48	33,23
45	7,30	7,64	10,23	14,00	36,93
50	8,63	8,97	11,08	17,74	40,09
60		13,91	15,34	21,93	50,64
70			26,42	34,07	62,34
80			35,79	43,87	84,40

UNI 6109 DIN 963

INOX A2 AISI 304

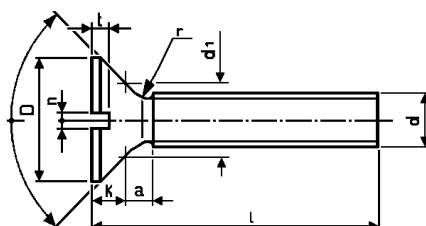

UNI 6109 - TSP - DIN 963

Viti testa svasata piana taglio cacciavite

Art. 1590	Prezzo base in € per 100 pezzi					
d	3	4	5	6	8	10
DxK	6X1,7	8X2,3	10X2,8	12X3,3	16X4,4	20X5,5
Lunghezza						
6	1,36	2,40	5,68			
8	1,48	2,51	4,37	5,30		
10	1,55	2,55	4,18	5,22	14,77	
12	1,70	2,69	4,46	5,47	14,77	
14	1,88	3,03	5,00	6,11	16,35	
16	1,88	3,03	5,00	6,11	16,35	42,87
20	2,17	3,36	5,54	6,87	16,35	38,73
25	2,55	3,87	6,43	7,76	19,52	42,87
30	2,88	4,39	7,09	8,61	23,74	44,93
35	4,02	4,80	8,37	9,46	31,12	49,58
40	5,50	5,87	9,11	10,48	33,23	55,78
45	7,30	7,64	10,23	14,00	36,93	67,14
50	8,63	8,97	11,08	17,74	40,09	70,75
60		13,91	15,34	21,93	50,64	91,93
70			26,42	34,07	62,34	113,10
80			35,79	43,87	84,40	134,28
90				70,00	109,20	158,55
100				93,33	129,48	176,63

UNI 6110 DIN 964

INOX A2 AISI 304

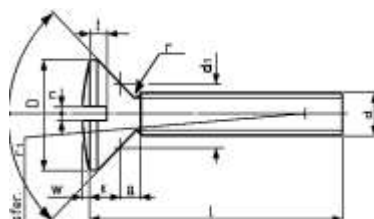

UNI 6110 - TGS - DIN 964

Viti testa svasata piana con calotta taglio cacciavite

Art. 1600

Prezzo base in €uro per 100 pezzi

D	3	4	5	6	8
DxK	6X1,7	8X2,3	10X2,8	12X3,3	16X4,4
Lunghezza					
6	1,36	2,40	5,68		
8	1,48	2,51	4,37	5,30	
10	1,55	2,55	4,18	5,22	14,77
12	1,70	2,69	4,46	5,47	14,77
14	1,88	3,03	5,00	6,11	16,35
16	1,88	3,03	5,00	6,11	16,35
20	2,17	3,36	5,54	6,87	16,35
25	2,55	3,87	6,43	7,76	19,52
30	2,88	4,39	7,09	8,61	23,74
35	4,02	4,80	8,37	9,46	31,12
40	5,50	5,87	9,11	10,48	33,23
45	7,30	7,64	10,23	14,00	36,93
50	8,63	8,97	11,08	17,74	40,09
60		13,91	15,34	21,93	50,64
70			26,42	34,07	62,34
80			35,79	43,87	84,40
90				70,00	109,20
100				93,33	129,48

UNI 6107-6109 DIN 84-963

INOX A2 AISI 304

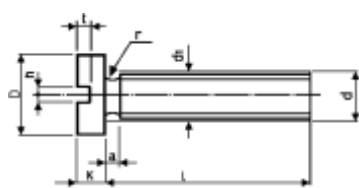

UNI 6107 DIN 84
Art. 1580

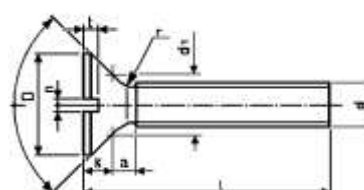

UNI 6109 DIN 963
Art. 1590

Microviti acciaio taglio cacciavite

Prezzo base in €uro per 100 Pezzi

DIAMETRO Lunghezza	M 2	M 2,5
4	2,29	2,40
5	2,07	2,17
6	2,07	2,17
8	2,03	2,17
10	2,22	2,36
12	2,22	2,36
14	2,40	2,43
16	2,40	2,51
20	2,77	2,88
25		3,98

UNI 7687-7688-7689 DIN 7985-965-966

INOX A2 AISI 304

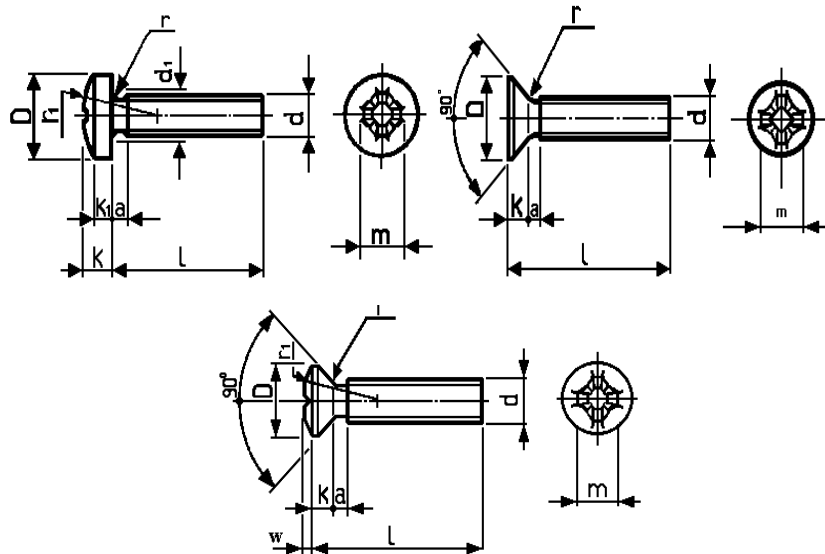

UNI 7687 - TC - DIN 7985
Art. 1601

UNI 7688 - TSP - DIN 965
Art. 1602

UNI 7689 - TGS - DIN 966
Art. 1603

Viti a metallo taglio croce

Prezzo base in €uro per 100 pezzi

D	3	4	5	6	8
DIN 7985 DxK	6x2,4	8x3,1	10x3,8	12x4,6	16x6
DIN 965 DxK	5,6x1,65	7,5x2,2	9,2x2,5	11x3	14,5x4
DIN 966 DxK	5,6x1,65	7,5x2,2	9,2x2,5	11x3	14,5x4
Lunghezza					
5	1,48	2,58			
6	1,40	2,40	5,68		
8	1,36	2,17	4,26	5,98	
10	1,44	2,32	4,14	6,02	15,91
12	1,59	2,43	4,49	6,15	15,91
14	1,74	2,77	4,92	6,79	17,61
16	1,74	2,77	4,92	6,79	17,61
20	1,96	3,06	5,42	7,34	17,61
25	2,32	3,43	6,20	8,23	21,02
30	2,58	3,84	6,86	9,08	25,56
35	4,46	5,98	8,06	9,93	33,52
40	5,50	6,42	9,80	11,50	35,79
45	8,11	8,49	12,47	14,00	39,77
50	9,59	9,96	15,15	18,20	43,18
60		15,42	16,66	23,89	54,54
70			26,42	34,07	67,14
80			35,79	43,87	90,90

UNI 7687-7688 DIN 7985-965

INOX A2 AISI 304

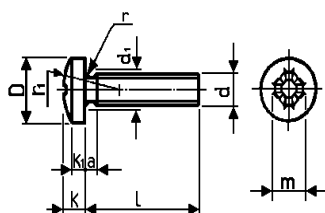

UNI 7687 DIN 7985
Art. 1601

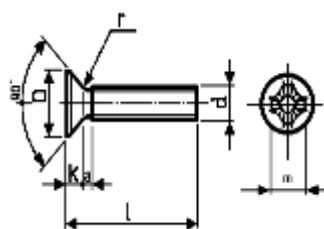

UNI 7688 DIN 965
Art. 1602

Microviti acciaio taglio a croce

Prezzo base in €uro per 100 pezzi

DIAMETRO Lunghezza	M 2	M 2,5
4	2,29	2,40
5	2,07	2,17
6	2,07	2,17
8	2,03	2,17
10	2,22	2,36
12	2,22	2,36
14	2,40	2,43
16	2,40	2,51
20	2,77	2,88
25		3,98

POILIERS

INOX A2 (AISI 304)



Viti POILIERS taglio cacciavite

Art. 1605

Prezzo base in €uro per 100 pezzi

D	4	5	6	8
DxK				
Lunghezza				
6	3,87			
8	3,87	5,97		
10	3,87	5,97	7,26	
12	4,19	5,97	7,26	
16	4,36	6,78	7,91	20,17
20	5,00	7,43	8,88	21,79
25	5,65	8,55	9,68	23,40
30	6,13	9,36	10,97	25,82
35	6,94	10,65	12,11	27,44
40	7,75	11,13	13,56	30,67
45		12,27	14,53	33,90
50		13,72	16,14	37,12
60		17,76	19,37	43,58

UNI 5732-65 DIN 603

INOX A2

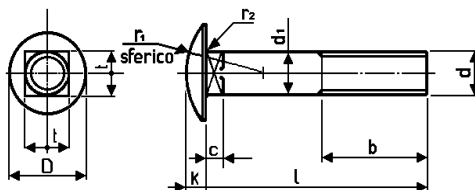

Bulloni a testa tonda quadro sottotesta

Art. 2610

Prezzo base in €uro per 100 pezzi

Filettatura d	M 5	M 6	M 8	M 10	M 12
LUNGHEZZA I					
16	8,61	13,77	20,66		
20	9,47	14,63	22,38	37,87	
25	10,33	15,49	24,96	41,32	
30	12,05	17,21	27,54	44,76	94,68
35	13,77	18,94	29,27	48,20	99,85
40	15,49	20,66	30,99	51,65	103,29
45	17,21	21,52	32,71	55,09	108,46
50	17,21	22,72	37,87	58,53	113,62
55		24,10	40,45	65,42	118,79
60	25,82	25,14	43,04	68,86	123,95
65		33,57	48,20	80,05	
70		37,87	49,93	82,63	129,11
80		51,65	58,53	94,68	141,16
90		68,86	72,30	120,50	154,94
100		86,08	86,08	129,11	172,15

Copiglie UNI 1336 DIN 94

INOX A2 AISI 304

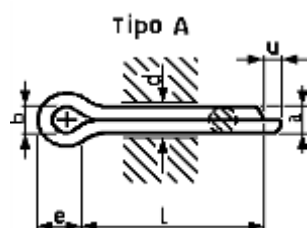

Art. 1700

Prezzo base in € per 100 pezzi

Lungh.	Diam.	1	1,5	2	2,5	3	4	5	6
10	0,81	0,81	1,68	2,16	3,66				
12	0,81	0,81	1,68	2,16	3,66				
15	0,81	0,81	1,68	2,16	3,66	5,44			
20	0,87	0,87	1,79	2,68	4,47	6,46	12,72		
25	1,03	1,03	2,07	3,18	5,28	7,59	13,80		
30	1,24	1,24	2,47	3,90	6,41	9,07	16,21	24,27	
35	1,37	1,37	2,70	4,31	7,05	9,94	17,61	26,57	44,96
40			2,91	4,72	7,68	10,76	19,00	28,81	48,29
45				5,23	8,51	11,88	20,73	31,68	52,50
50					9,30	12,96	22,48	34,54	56,68
60						15,75	26,98	41,96	67,62
70							29,73	46,50	74,18

Rondelle grembiuline UNI 6593 - DIN 9021 INOX A2 AISI 304

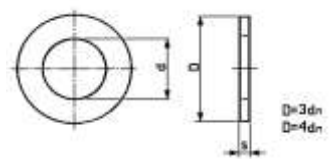

Art. 1671

Prezzo base in €uro per 100 pezzi

Ø Foro x Ø Esterno	4x12	4x16	5x15	5x20	6x18	6x24	7x21	7x28	8x24
Prezzo	1,47	3,36	2,30	5,99	3,06	10,12	18,59	25,20	7,32

Ø Foro x Ø Esterno	8x32	9x27	9x36	10x30	10x40	12x36	12x48
Prezzo	17,31	34,71	60,94	13,05	39,94	26,63	63,91

Rondelle piane UNI 6592 DIN 125 INOX A2 AISI 304

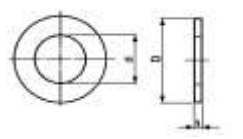

Art. 1670

Prezzo base in €uro per 100 pezzi

Per viti da mm	3	4	5	6	8	10	12	14	16
Prezzo	0,51	0,67	0,84	1,53	2,45	4,47	7,59	12,08	14,38

Per viti da mm	18	20	22	24	27	30	33	36	39
Prezzo	21,30	22,77	28,49	55,12	72,43	83,88	121,05	153,33	216,27

Rondelle grower
UNI 1751 DIN 127
INOX A2 AISI 304

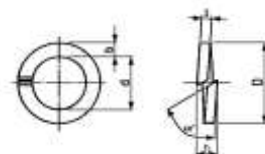

Art. 1680

Prezzo base in € per 100 pezzi

Per viti da mm	3	4	5	6	8	10	12	14
Prezzo	0,67	0,72	0,97	1,61	2,56	3,84	6,45	10,31
Per viti da mm	16	18	20	22	24	27	30	
Prezzo	14,27	17,95	24,51	28,92	46,97	50,14	125,71	

Rondelle dentellate
DIN 6798 / A - J
INOX A2 AISI 304

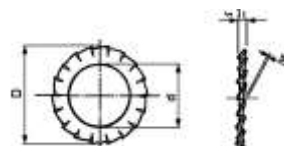

INTERNE "J" Art. 1690
ESTERNE "A" Art. 1691

Prezzo base in € per 100 pezzi

Per viti da mm	3	4	5	6	8	10	12	14
Prezzo	1,06	1,31	1,47	2,13	3,36	5,99	7,60	11,48
Per viti da mm	16	18	20	22	24	27	30	
Prezzo	14,65	27,70	33,88	45,19	54,87	72,63	80,70	

Barre filettate

DIN 975

INOX A2 AISI 304



Filettatura sistema metrico

Art. 1520

Prezzo base in €uro per 100 pezzi

Diametro	3	4	5	6	8	10	12	14	16
Euro	155	155	170	176	320	496	754	997	1312

Diametro	18	20	22	24	27	30	33	36
Euro	1678	2076	2680	3553	4715	5841	8718	11042